

Check List for Pressure Measuring Instruments with Chemical Seal

Inquiry No. Ordering No. Name/Company/Address

Application (short description)

Quantity

Pcs.

Pressure measuring instrument / if required: electrical accessories (ordering code resp. description of instrument provided)

Attention please: A mounting device is required for systems with capillary line! Please choose for pressure gauges:

Gauge holder bracket, distance 60 mm 100 mm 160 mm Material aluminum black stainless steel

Front mounting flange

Rear mounting flange

Chemical Seal

Diaphragm seal (MDM) In-line seal (RDM) Capsule seal (TDM)

Model:

Installation at EX zone 0: No yes (with Adapt FS according data sheet 11001)

Process connection:

PN:

DN:

For RDM :

Suitable for tube diameter (inside) mm

For MDM with extension:

Length of extension tube mm

Medium

gaseous liquid viscous abrasive

Material of wetted parts:

Standard, as in referring data sheet Special material:

Max. operating pressure:

Statical bar / dynamical from to bar / Frequency Hz

Could vacuum occur?

No yes, smallest absolute pressure mbar

at temperature: °C

Working temp. (t_A):

Medium °C constant, or min. °C / max. °C

Dial inscription t_A = °C (will be calibrated accordingly)

Cleaning temp. (t_R):

At chemical seal max. °C / duration of cleaning h

Ambient temp. (t_{UD}):

At measuring instrument °C constant, or min. °C / max. °C

Ambient temp. (t_{UF}):

At capillary line °C constant, or min. °C / max. °C

Outdoor application:

No yes

Filling fluid:

Selection suitable for above stated temperatures

Further requirements: for oxygen for chlorine silicone free

food compatible FDA approved

others:

Certificates:

no 3.1 for wetted parts others:

Accessories:

(e.g. process connection pieces, flushing rings etc.)

Mounting:

see page 2



ARMATURENBAU GmbH

Manometerstraße 5 • D-46487 Wesel - Ginderich
Phone: (0 28 03) 91 30-0 • Fax: (0 28 03) 10 35
armaturenbau.com • mail@armaturenbau.com



Subsidiary Company and Sales East Germany and Eastern Europe

MANOTHERM Beierfeld GmbH

Am Gewerbepark 9 • D-08344 Grünhain-Beierfeld
Phone: (0 37 74) 58-0 • Fax: (0 37 74) 58-545
manotherm.com • mail@manotherm.com

Check List for Pressure Measuring Instruments with Chemical Seal

Mounting

according to drawing no.:

Ref. drawing no. 16-21:

Length of capillary line $L =$ m $H =$ m

With flexible armor other special options:

Ref. drawing no. 1-15:

Cooling element no yes, length 100 mm length 200 mm

Special options (data sheet 7002):

Drawings for differential pressure measuring instruments for level and flow-through indication: see additional check list.

Direct Mounted Diaphragm Seal (MDM)

Drawing 1

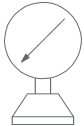

Bottom connection

Drawing 2

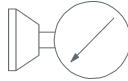

Left-sided connection at 9 o'clock

Drawing 3



Top connection at 12 o'clock

Drawing 4

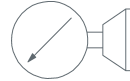

Right-sided connection at 3 o'clock

Drawing 5



Back connection

Direct Mounted In-line Seal (RDM)

Drawing 6

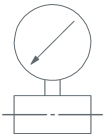

Drawing 7



Drawing 8

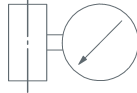

Drawing 9

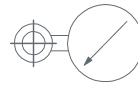

Drawing 10



Drawing 11

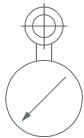

Drawing 12

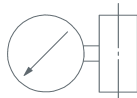

Drawing 13

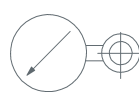

Drawing 14

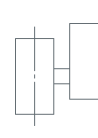

Drawing 15

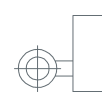

MDM Mounted with Capillary Line

Drawing 16

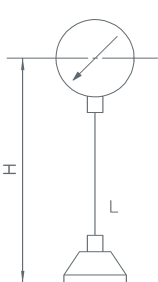

Drawing 17

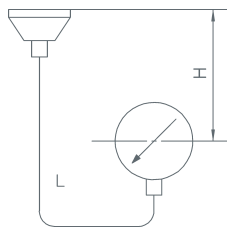

Drawing 18

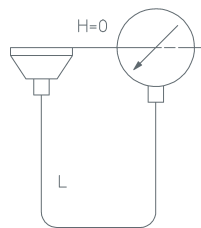

Drawing 19

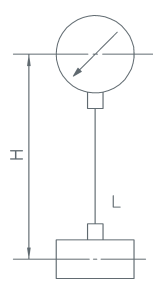

Drawing 20

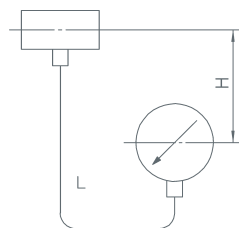

Drawing 21

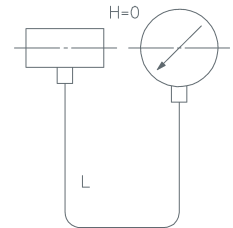

The drawings 16 to 21 for mounting with capillary line show pressure gauges with bottom connection at 6 o'clock only. Please combine the drawings for other connection positions of the measuring instrument!

Example: Pressure gauge with **back connection**, mounted 3 m **above** an in-line seal, length of capillary line 5 m
Description: Mounting according to drawing no.: 15, 19, length of capillary line $L = 5$ m, $H = 3$ m

Important Notes for Mounting with Capillary Line

➔ If **vacuum** occurs or possibly could occur, the pressure measuring instrument has to be mounted at least 40 cm below the chemical seal (drawing 17 for MDM, drawing 20 for RDM)!

➔ A mounting device for the pressure measuring instrument is required if connected with capillary line to the chemical seal (compare page 1, first par.)

Specifics:

Customer will treat the instruments by autoclave at 130 °C

Required control volume for instruments of other brand's that shall be mounted:

Others: